



CORNWALL
ASSOCIATION OF
WOODTURNERS



June 2024

In this months Edition

Breaking News - Results in from the EGM

Your NEW Committee

Committee roles and Responsibilities

TOTY Categories

This months 'HOLLOW FORM' comp winning entries

Presentation by Mike Hosking - Finials

Club notice board and upcoming events

New Webpage details

Readers Contributions (pinched from 'Woodturner' again!)

Classified Ads are back!

Woodshop contents and prices



**BREAKING
NEWS**

Resulting from the
vote during Friday's EGM - Your club
is now.....

.....Going to apply
for Charity status

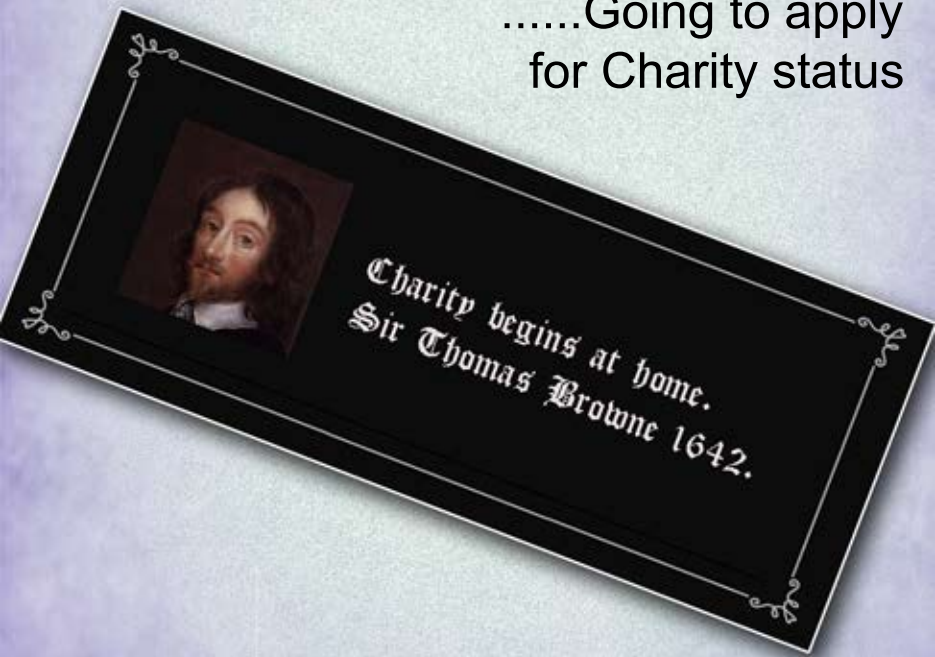

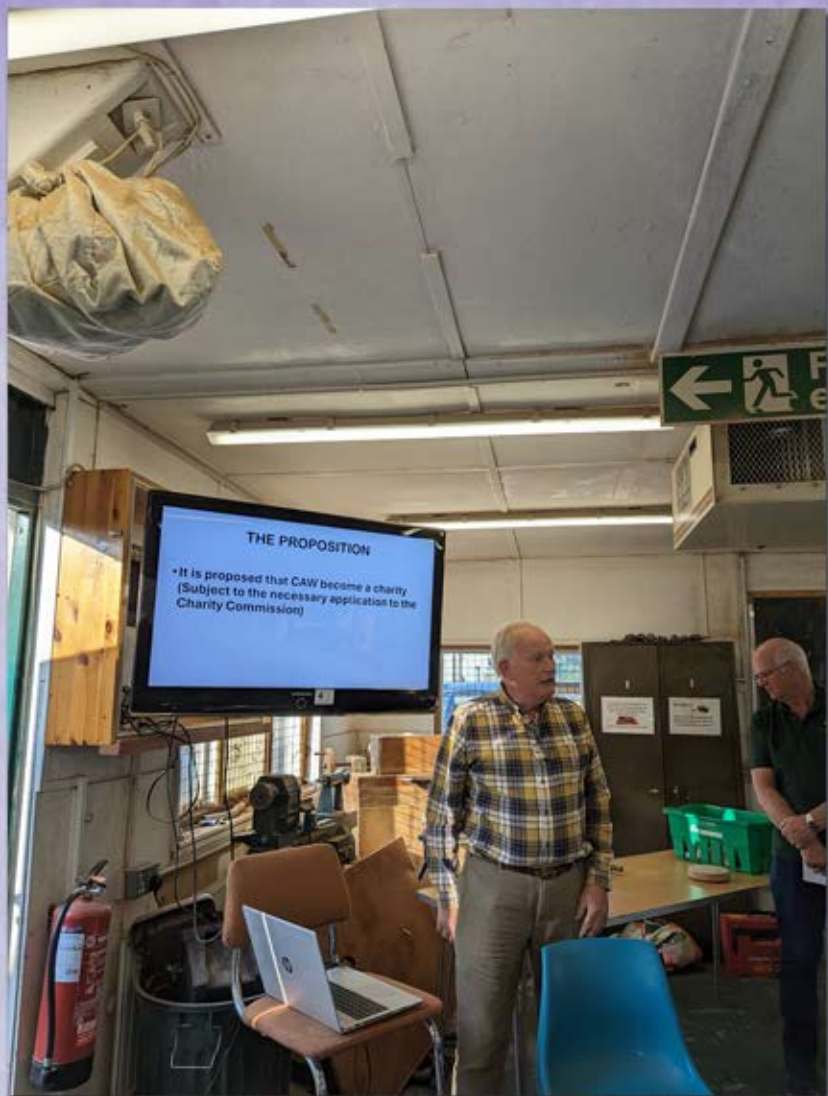

Brian gave a presentation to those present at the EGM as to why the club should apply for charity status

The vote was unanimous in favour - motion passed.

For the benefit of those not present a copy of Brian's presentation follows.

ITS “OC-OF” TIME

•Pronounced OC(K) – OF(F)

• Meaning

•**OUR CLUB – OUR FUTURE**



EGM - NEW PREMISES UPDATE

THE PROPOSITION

- **It is proposed that CAW become a charity (Subject to the necessary application to the Charity Commission)**

CLUB STRUCTURE

- Funding available for an “association” is very limited in the trusts/grants arena a Charity status would make it easier to attract grant funding
- Charitable Incorporated Organisation (CIO's) were introduced in 2006. The legal framework for CIOs is set out in the Charities Act 2011 and additional CIO-specific regulations in 2012.
- The main financial advantage to us would be that we could claim tax back on gifts, donations, attendance fees and membership fees. Secondly it would make it easier to attract grant funding.
- We would require minimum of 3 Trustees, but the roles wouldn't be any different to that of the committee.
- Charities Commission require transparency as accounts need to be externally audited annually and we would need to submit accounts to the commission each year along with an annual report of the charity's activities and how it has met its objectives that year.

THE TRUSTEES

• It is proposed that Trustees be formed from the current executive :-

- Nick Dodge
- Brian Hobbs
- Chris Gladwell
- Mary Murfin

AWPIGS TASK LIST

- Membership background task - How many members are ex-service men & women, police, NHS etc., is an important factor in fund raising.
This increases the number of support charities we can approach.
- Planning building task – The development of an appropriate building design is essential to ensure appropriately sized new premises are provided. This may also involve preparing planning submissions
- Cost planning task – The development of an encompassing budget plan is essential. We need to include cost of “free” labour for internal fitting out of the building, along with interior material costs
- In-house fund-raising task – Creating a diary of fundraising events for internal and external fund raising .
- Support to professional fund raiser task - Responding too and supporting the efforts of the professional fund raiser be providing necessary data or documentation as submission may require .
- Accounting record task – Keeping appropriate financial records as to funds and grants raised
- Club change of constitution task - Completing all necessary task to register the club as a charity
- Membership progress updating task - Ensuring members are aware of progress and needs for further support
- Wheal Jane liaison task - Regular meetings with Wheal Jane key staff and project manager as project progresses



Brian then finished off by successfully insulting Mary with references to an old childrens TV show!





Your new C.A.W Committee 2024 - 2025.

Nick Dodge
Chair
Health & Safety Officer
Teaching Co-ordinator
External Events
nickdodge@hotmail.com
07532 206823

Brian Hobbs
Vice-Chair
Charity Officer
brian.hobbs@mjmedical.com
07818 401590

Chris Gladwell
Treasurer
chris@chrisgladwell.co.uk
07967 968556

Mary Murfin
Secretary
Membership
marymurfin1@gmail.com
07790 986105

Dave Frost / Jane Miners
Quartermaster
daveyfrost@hotmail.co.uk
07485 425022

David Evans
Shop Manager
evans3518@outlook.com
07817 623336

David Sadler
Workshop Manager, + Tutors Rep
davidsadler0504@gmail.com
07966 303365

Jonathan Nicholls
DPA/CPA Officer
jonathan.nicholls@sky.com
07786 015938

Morag Clark
Events Co-ordinator Internal
moragclarkms@gmail.com
07484 313183

Rob Graham
Social Media Moderator
robgraham@gmail.com
07966 651780

Pete Stubbs
Webmaster/Magazine Editor
webmaster4caw@gmail.com
07791 334925

Jane Miners
Caretaker
Janeminers65@gmail.com
07443 626984



Committee Roles



Nick Dodge

Chairman

Responsible for the management of the club, guiding the club both strategically and in day to day matters, and supported by the committee.



Brian Hobbs

Vice Chairman

Provides direct assistance to the Chairman, sharing the workload as agreed with the Chairman.



Mary Murfin

Secretary

Responsible for and maintains all club records and member communications. Maintains membership records, new, existing and renewals.



Chris Gladwell

Treasurer

Responsible for and maintains club financial records.



David Sadler

Tutor Representative
Workshop Manager

Represents Tutors at committee meetings



Jonathan Nicholls

Data Protection Officer
Child Protection Officer

Ensures that the club promotes and adheres to legal data & child protection protection policy requirements



David Evans

Shop Manager

Responsible for maintains stock, keeping sales records. Supported by nominated sales assistants to ensure that the club shop is open to club members on turning nights and at clubhouse events.

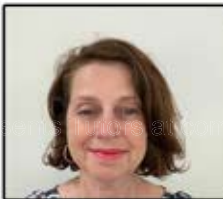

Jane Miners

Caretaker
Quartermaster

Responsible for maintaining the club stocks related to catering, cleaning and hygiene products

Pete Stubbs



**Webmaster
Magazine Editor**

Responsible for the creation and maintenance of the club website
Compiles and publishes the club magazine supported by members contributions.
Is not responsible for creating all content

Rob Graham



Social Media Moderator

Responsible for approving user access and for ensuring content is appropriate

Morag Clark



Internal events Co-ordinator

Organises club events

Further roles by committee members already mentioned above

Nick Dodge:

Teaching Coordinator

Responsible for maintaining the waiting list and for inviting prospective members to teaching sessions

Health & Safety Officer

Responsible for ensuring that all club activities adhere to health and safety guidelines, for maintaining the club Risk Assessment, and for bringing health and safety issues to the immediate attention of the Chairman. Reports monthly to the Committee.

Non Member Enquiries

Responsible for directing responses to enquiries received via the website

External events Co-ordinator

Organises club events, including external demonstrations and participation at external events

Brian Hobbs:

Club Night Raffle

Charity Fundraising Liaison Officer

Provides day to day liaison with the nominated club charity

Other volunteer (Non Committee) members Roles.

Tutors

Sue Butler,

Dave Chamberlain

Jim Davies

Terry Edwards

Gary Finnemore

Colin Gooch

Mike Hosking

Lawrence Moody

David Sadler

Guide and instruct members with their knowledge and expertise. Members appointed as tutors from 2019 are required to obtain AWGB accreditation prior to being appointed

Tutors Assistants

Ron Ashenden

Nick Dodge

Gordon Fairhurst

Provide emergency support to tutors on teaching nights to prevent the cancellation of sessions.

TOTY & Trophies Co-ordinator

Sue Butler

Responsible for running the club turning competitions and for associated awards

AVI Equipment setup & operate

Graham Murfin

Ensures that the club AVI equipment is set up for use as required for club events

Catering

Vicky Thomas

Supervises the provision of catering at club events

Shop Assistants

Ron Ashenden

Colin Gooch

Rob Graham

Lawrence Moody

Assist the Shop Manager opening the shop for a brief period on turning nights

Turner Of The Year (TOTY) Runs from November to October



Categories for Beginners, Novice, Intermediate and Advanced.

January - Box - Any turned item with a lid

February - Natural Edge Bowl - A turned bowl with a natural edge

March - Goblet - A drinking vessel with a stem

April - Open - Any turned item

May - Hollow Form - A hollow item where the inside has been turned blind

June - Miniature & *Collaboration* A turned item that when complete fits inside a 35mm film case *Collaboration* - see below

July - Toy - A turned item allowing you to use your imagination

August - Platter - A shallow plate, flat for at least 3/4 across the inside base

September - Bowl - A bowl turned from any wood

October - Decorated Turned Item - A turned item decorated in any way

November - Matching Pair - A pair of turned items of the same size

December - Open, *Collaboration Trophy* & *Christmas Trophy*

Open - Any turned item *Collaboration Trophy* and *Christmas Trophy* see below

Collaboration Trophy in June and December - An item undertaken by 2 or more members from different categories: Junior, Beginner, Novice, Intermediate and Advanced (Guild)

Christmas Trophy

'AN OBJECT WITH WHEELS' is this years Christmas Trophy competition, For which there can only be one winner.

At least part made on a lathe. - All entries will be put to the test!!!

Medal winners for May 2024
'HOLLOW FORM'

ADVANCED CATEGORY

(After Brian Hobbs has put his files back
on the shelf above the TOTY entries)



Medal winners for May 2024
'HOLLOW FORM'

ADVANCED CATEGORY



Gold Medal to Mike Hosking



Silver Medal to Dave Cusick



Bronze Medal to Nick Dodge



Medal winners for May 2024
'HOLLOW FORM'

INTERMEDIATE CATEGORY



Gold Medal to John Bray



Silver Medal to Morag Clark



No entries for Bronze

Medal winners for May 2024
'HOLLOW FORM'

NOVICE CATEGORY



Gold Medal to Brian Hobbs



No entries for Silver



No entries for Bronze

Medal winners for May 2024
'HOLLOW FORM'

BEGINNER CATEGORY

**NO ENTRIES
PLACED IN THIS CATEGORY
THIS MONTH**

Club Nights.



This months demonstration was
'finals' by Mike Hosking.



Some excellent examples brought in by Mike



**Two of the finials produced by Mike
as part of his demo.**

Many thanks to Mike for an excellent and informative demo



CLUB NOTICE BOARD AND UPCOMING EVENTS

Please remember that your membership renewals are due on 1st July.

Banking details

We now bank with NatWest, Truro.
The club account details are:
NAT WEST, TRURO

For membership payments, etc please use:
52-41-31
45336644

For 100 Club BACS payments please use:
52-41-31
45336636

Upcoming Events. Club Nights.

June

Boxes with Ron Ashenden.

TOTY: Miniature, (A turned item that when complete fits inside a 35mm film case).

And Collaboration, (An item undertaken by 2 or more members from different categories).

July

Beginners Special with David Cusick

TOTY: Toy - An turned item allowing you to use your imagination.

Don't forget that June is the next 100 Club draw. If you don't have any tickets yet - then don't delay!

DEMO NIGHTS.

Usually held twice a year. We invite professional turners from across the country to come to the club and demonstrate.



it's time to

**RENEW YOUR
MEMBERSHIP**

All current membership will expire on the 30th June 2024.

Renewals must be paid on the 1st July or before in line with our insurance requirements.

If you do not wish to renew your membership,
please email: cawsecretary@outlook.com or text: 07790 986105.
This will avoid follow up reminders for your subscription.

Renewal subscriptions remain the same as last year:

- * £40 Full member
- * £20 Associate member (Direct relative of existing full member.
- * £20 Junior member (£10 Associate Junior member)

On receipt of your subscription,
Mary will issue your 2024/2025 Membership Card.

Payment options:

At the Club Night (cash or cheque) - Friday 28th June.

OR

(During the first week of July). You can place your renewal payment in the white mail box in the break room.

OR

You could send a cheque payable to
Cornwall Association of Woodturners to:

Mary Murfin,
CAW Secretary,
57 Church Way,
Falmouth.
TR11 4SG.

OR

You can pay by BACS direct to the CAW Bank Account.
If using BACS please email Mary your date of payment so she can update her records and issue your membership card.
NAT WEST TRURO.
SORT CODE: 52-41.31
ACCOUNT: CORNWALL ASSOCIATION OF WOODTURNERS.
A/C NUMBER: 45336644
REFERENCE: YOUR NAME.

Please advise Mary of any change to your address or contact details when renewing your subscription.
This will ensure our records are up to date.

If you have any queries call, text or email Mary.

A new web page for the club



It has been decided by the committee that the club web page has been in need of modernisation and a new server has been acquired to take us into the 21st century.

I have subsequently now put together the new feel website which can be found at the same address as our old one was:

<https://cornwallassociationofwoodturners.co.uk/>

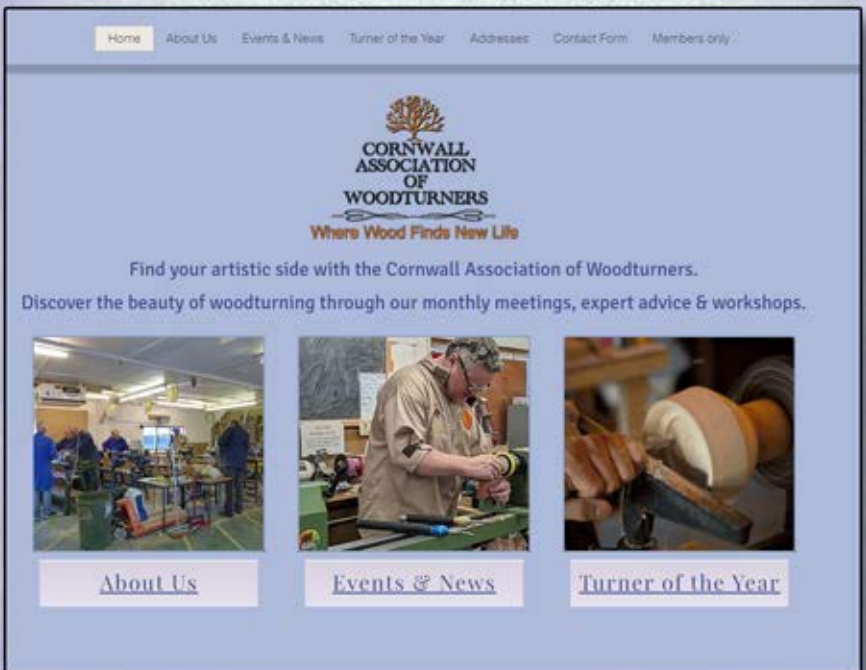

You will find that there is a members only area on this new site and that is password protected.

The password is whealjane

If anyone has any ideas, suggestions or content for either the website or the members area please contact me at webmaster4caw@gmail.com

A RAFFLE LIKE NO OTHER.



Since being promoted to Vice Chairman, Brian 'this is the winning ticket' Hobbs, has really upped his game with regards to raffle prizes. Members present on Friday night were given the chance to enter the raffle with a laptop as 1st prize.



However, once all tickets had been sold, he did then swap the prize out for a cardboard clock face

READERS CONTRIBUTIONS

If you have anything to contribute, please contact me at
webmaster4caw@gmail.com

Well it seems that my attempt to encourage some entries by doing yet another one myself last month - failed.....

.....It's another empty page again



Therefore to fill out
the blank spaces....

...I've nicked another Woodturner article!



Our stolen article from 'WOODTURNER' for this month is an article by RICHARD FINDLEY on How To Turn Perfect Spheres.

Turned wooden spheres hold a certain fascination. They demand to be picked up and rolled in the hand, they show off the figure of the timber and they also hold a mystery to turners and non-turners alike: just how do you turn this perfectly symmetrical shape without marking it?

It's actually not that difficult to do, but there are several stages involved. The method I will show in this article is the simplest way that I have found, but it is by no means the only way.

I've seen lots of variations, some involve some very careful marking out, some involve some mathematical formulae or the use of jigs. The beauty of the way I do it is that it is pretty much foolproof!

The blank

The first stage with any turning is sorting out the timber.

The spheres I show being turned in this article were for a customer who specified soft wood spheres,

110mm in diameter with a 16mm hole drilled through the centre.

The hole needed drilling first, but isn't relevant to making a sphere, so I need not go in to any details about that, suffice it to say, the holes make no difference to the making of a sphere.

To achieve 110mm, I laminated two pieces of 65mm European redwood together, to give me a blank of around 130mm thick, and cut it around 150mm long.

The beauty of this project is that you can make your sphere from literally any wood, to any size you like and the technique to create the spheres will be just the same as I show here.

Templates

The next step is to make a sphere template.

It is quite possible to make without a template, but to minimise the work later on, a template will make life much easier. I use an offcut of MDF and draw a curve with a radius to match the sphere, in this case 55mm.

The beauty of a sphere is that it should be the same in every direction, so I only make about a quarter of a circle, but you can make as much of the curve as you like.



Cutting the template on the bandsaw. Notice the relief cuts which make it much easier to produce a smooth curve



MDF template cut to the radius of the sphere

First stages of turning

With the blank held between centres and roughed to a cylinder of the correct diameter, the next stage is to mark out the sphere.

In this case I drew two lines to mark the 110mm sphere and a centre line at 55mm, simply marking them with a pencil and ruler.

Using my 10mm beading and parting tool, I then turned down the waste at each end, leaving enough solid timber to give a positive drive, but not so much as to get in the way when shaping the ball.



Using my 12mm spindle gouge I then began to shape the block into a ball. I find it best to do this gradually, first rounding off the corners, then, with each cut, increasing the curve. It is important here to keep an eye on the overall shape; to do this I will tend to work on one side until it begins to resemble a sphere, then go to the other side and balance out the shape. It is important to realise when turning a sphere, that the curve begins on the central line - or the equator if you like - there are no flats on a sphere just curves, so make sure you cut right from the line.,





Initially the template will show up how far from perfect your sphere is



but trust the template and continue to work until it is spherical

Start checking

As the globe shape emerges from your blank you can bring the template into play. As long as you paid close attention to making the template and did it accurately, you can trust the template.

If you are not going to believe what it's telling you, there was no point in making it!

By now your orb should be looking quite spherical, but the chances are your template will tell you it isn't.

Take the blank out of the lathe and turn it on its end so the poles are top and bottom. It is often surprising how this will show you how spherical your ball isn't... well! little by little, cut by cut, remove small amounts of timber as your template guides you and soon enough, you should have a nearly perfect sphere with a relatively small block of waste at each end.

With the shaping process, the waste blocks will naturally reduce in size, to the point where they are greatly reduced but still securely driving the blank.

Removing the Waste.

There are several ways that you could remove the waste, but the safest way is to saw it off with a hand saw. Parting on the lathe would only remove the waste from one end so you would still need to saw off the other waste block anyway and using a bandsaw could potentially be dangerous - if the blade grabbed the wood and spun the sphere it could endanger your fingers.

With the waste removed all that is left to do is to tidy up the cut marks, but potentially the sphere might not be 100% perfect,

so it would be useful to be able to remount the ball on the lathe in such a way that it would allow the removal of the cut areas and to correct any imperfections in the first turning and shaping stage... well there is a way, and this is the beauty of this method of making spheres and the part that makes it foolproof. In addition, it is an easy method to follow as well as inexpensive to create the parts to make it work

Wooden mounting cups

To achieve this secondary holding method we need to turn some wooden cups to hold the sphere securely without marking it. I chose two pieces of tulipwood, a relatively soft hardwood of around the same density as the redwood I used for the balls.

One is simply held in the chuck and turned to a cup shape, the other needs to fit onto your live centre. I am fortunate that I own a Oneway live centre which features a threaded portion, designed to hold various attachments and homemade holding devices such as the wooden cup needed here. These centres are acknowledged to be one of the best on the market, but have a price tag to match. There are now some very similar versions available.

To make accessories for this style of live centre, you need to buy a tap that matches, in this case a 3/4in x 10tpi UNC, but check your centre to find the correct size. Any wood can be tapped; evidence of this is the fact that I have used this soft tulipwood here, but you need to select a piece of side grain like a bowl blank, rather than like a spindle - as this will hold the thread, whereas the threads cut into an end grain blank will just crumble, unless you use a very dense wood, but this wouldn't be suitable in this case.

I cut a square of timber, oversized in all directions, pilot drilled a hole and tapped out the thread. I'm sure an engineer would wince at my tapping technique, but it does the job!

With the thread cut, I fit the block onto the live centre.

With a drive centre in the headstock, I bring the tailstock up and engage the centres until the block spins and I turn it to a cylinder.

This can then be removed from the live centre, reversed, and held in the chuck to turn the cup shape into the face.

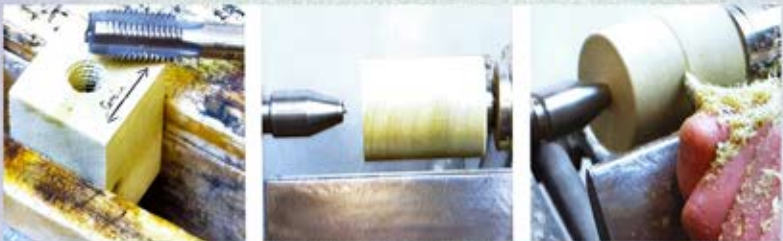

What if I don't own a fancy live centre?

If you don't have this sort of centre, it isn't a problem because you can turn a similar version to sit over your live centre to do the same job.

The process is similar to making a box, in that you hold the blank in the chuck and turn out the inside, deep enough to accommodate the live centre and to a diameter that is a tight push fit over the parallel section of the live centre.

At this point you can mount it and drive it between centres as I described for the threaded version.

The main difference here is the grain direction, because the threaded version is cross grain, which means turning it needs a little more care and the use of a spindle gouge to cut it cleanly, but the standard push fit version will be end grain and can be simply turned, as a spindle. with a roughing gouge.



Turning out the hollow for the live centre to fit, using the wing of the gouge, just like hollowing a box



MDF template cut to the radius of the sphere

Once the fitting is made and turned true, mount it in the chuck and turn a cup shape into the face. Again the grain direction is relevant here, as the cross grain version will need turning from the rim down to the bottom, like a bowl, where the end grain version will need drawing out from the centre to the rim with the wing of the tool like a box.

The exact shape of the cup is important here; too deep and only the rim will drive the ball, which will certainly leave ring-shaped dents in the sphere.

You need to turn the cup slightly too shallow, which means that a good proportion of the bottom of the cup will drive the sphere, but importantly the rim won't come into contact, leaving the sphere blemish free.

To achieve this, I cut out the same radius curve on the other side of the template and turn the cup to suit ensuring the rim doesn't come into contact with the template, and so the sphere.



Use a template to turn the correct shaped cup. Ensure it isn't too deep so the rim can't damage the sphere as it drives

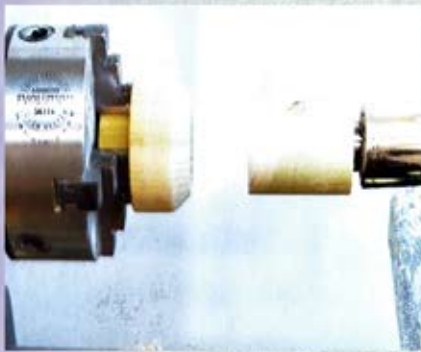

Wooden cups, ready for action

With the cups turned the sphere can be remounted. It is important to understand the grain direction of the sphere before starting to turn it. You need to ensure the poles of the globe are directly up and down, or north and south, to ensure a clean cut.

When turning the blank initially, it was a standard spindle blank, so the cuts ran from the equator, down to the poles. Now, with the blank mounted between cups, it becomes faceplate work, so the cuts will be drawn apparently uphill, but still from the equator to the poles, and so still working with the grain of the wood.

What you can't do at this stage, is to mount the sphere with the poles running diagonally because then you won't be cutting consistently with the grain: at some point you will be working against the grain. I'm not one to say this will never work, but it will be making life difficult for yourself when it comes to achieving a good, even surface finish.



The sphere held in the wooden cups by its equator, the poles are straight up and down

The grain of the sphere in this picture shows clearly which way it wants to be cut. but if you mount it diagonally you will always be working against the grain at two points in each rotation

Turning between cup centres



Use the wing of the tool in a shear cutting action to achieve the best results



You can see the tooling marks on the sphere, which shows how this method automatically corrects any imperfections in your freehand sphere turning

With the sphere held at the equator by the cups, and the poles running directly vertically, you can finish turn the sphere.

Light cuts with the wing of the tool in a shearing cut work really well here. This is when it becomes clear just how simple this all is, because as you turn in this new orientation, the waste marks will be removed and, because the lathe simply spins the sphere, you will automatically be removing anything that wasn't perfectly spherical from the earlier operation.

Because you are using a light shearing cut, working with the grain of the wood, it cuts cleanly and a sphere is formed almost effortlessly.

Check the sphere regularly and reposition it in the cups occasionally, but only by rotating it around the equator, so a different portion of the sphere can be turned.

Once it is all turned and the cut off marks are gone, the sphere is ready for sanding.

The completed spheres

The sanding process is even more simple. I worked from 120 grit to 240 grit on these softwood spheres, but you might choose to go finer.

You can sand in any direction, so now you can feel free to mount the ball in whatever orientation you like between the cups; just try to ensure every surface is worked evenly.

Very quickly, you will find you have a perfectly smooth and spherical ball





CLASSIFIED ADS

Classified Ads are back...



Jet mini lathe & almost 40 tools

£250 ono

All enquiries to Lawrence Moody.





For years, our club has supported numerous charitable causes through your generous donations and volunteerism. We've made a positive impact in our community by rallying together for great organisations.

However, the tables have turned, and now it is our club itself that is in dire need of your charitable support.

As you know, we hope to register as an official charity with the goal of raising funds to secure new premises for our club to call home.

The harsh reality is that we are losing our current facilities and without a new home base, the very existence of our club is in jeopardy.

We cannot afford to let the years of cherished memories, camaraderie and tradition embodied by our club simply fade away.

Whilst a small committee of dedicated members has been supportive, the overwhelming majority of you have not yet had a chance to step up to this crucial cause.

We compassionately implore every able member to:

- Support internal fundraising efforts by YOUR committee such as (at the very least) buying one or more tickets for the 100 club - the profit from which is for YOUR club.
- If you are unable to buy a ticket for the 100 club, then maybe volunteer your time and skills to fundraising efforts for your club yourself!

Spread the word about our plight to friends/family who may also support.

Our club's legacy and future is in YOUR hands.

Your committee can only do so much, but they cannot actually buy the new premises themselves whilst you sit back and do nothing!

Dig deep, and let's rally together as a true community to save something deeply meaningful to us all.

We also need particular skills to help the project as we move forward. Please talk to Brian Hobbs about what skills these are.

The club needs you now - more than ever before.



Wood Blanks

Various types (inc pen blanks) From £1.50

Abrasives & Accessories

Mirca Abranet		
70 x 125 Mixed pack (80,120,180,240,320,400)		£4 per pack
80 grit single pieces		£1 each
Hook & Loop 150mm x 0.5mm 6 x mixed grits		£9.40 per pack
J Flex		
115mm x 1m (80,100,120,180,240,320,400,600 grits)		£3 per grit
Mirka Caret Flex		
115mm x 0.5m (180,240, 320, 400 grits)		80p per grit
Nyweb		50p
Sanding paddle		£8.20
Interface Pad	70mm x 200mm	£7
Mirka backing pad	10mm	£10
Robert Sorbey Pro Edge Abrasive Belts		
Ceramic	(80 or 129 grit)	£4.85 each
Alluminium Oxide	(180 or 240 grit)	£2.50 each

Finishing Products

Cellulose Sanding Sealer Spray		£9
Cellulose Sanding Sealer	500ml can	£10.80
Acrylic Sanding Sealer	Spray	£8.10
Woodwax 22	450ml Clear	£11
Woodwax 22	4509ml Mellow or Golden Brown	£10.25 each
Liming Wax	450ml	£12
Microcrystalline Wax	225ml	£11.40
Cut'n'Polish	225ml	£14
Hard Wax Oil	500ml Gloss or Satin	£16.50
Ebonising Lacquer	400ml Acrylic Spray	£8.50
Burnishing Cream	500ml	£13.20
Friction Polish	500ml	£16.20
Tung Oil	500ml	£10.80
Lemon oil	500ml	£10.80
Finishing oil	500ml	£10.20
End Seal	1,000ml	£9.90
Spray Lacquer	400ml Acrylic Glass or Satin	£8.10
Spray Lacquer	400ml Melamine Gloss	£9

Finishing Products Continued

Spirit Stain	25ml	£1.50 each
Spirit Stain	25ml Teak, Pine, Rosewood or Yew	£1.50 each
Spirit Stain	12 x 25ml Pack of mixed colours	£15.50
Club Mix Cellulose Sanding Sealer	1ltr (Diluted 50/50)	£7
Food Safe Chopping Board Oil Natural		£4
CA Glue	20g Medium Viscosity	£1.20
CA Glue	50g Medium viscosity	£4
CA Glue	50g Low Viscosity (Thin)	£5
Beeswax Stick		£2.25
Liberon Coloured Wax		£3.75
Pritt Type glue sticks		75p
Hot melt glue sticks	11mm x 270mm	25p each
Superglue	Gorilla, Sealfix or Loctite	£5 each
Superglue	Bostik or Poundland	£1 each

Project Kits & accessories

Bud Vase tubes	Small single	25p each
Bud Vase tubes	Small pack of 5	£1
Bud Vase tubes	Medium single	20p each
Bud Vase tubes	Large single	50p each
Mini key ring pen kit	Chrome	£2.75
Cigar pen kit	Satin	£4.50
Pen Kit	Slimline	£2.60
Inserts	Slimline	£2
Refils	Slimline	50p
7mm tubes	Pack of 4	£2.20
Twist pen refills	Blue or Black single	50p
Twist pen refills	Blue or Black Pack of 5	£1.75
Twist pen refills	Blue or Black Pack of 10	£4.50
Pen bags	Various colours single	60p
Pen boxes Plastic	single	50p
Candle cups	Brass single	£1
Candle cups	Steel(with bezel) single	£2.50
Candle cups	Copper single	£1
Candle cups	Brass pack of 4	£6.50
Candle cups	Tea light cups	75p
Bottle Openers		£4.50
Letter Opener		£5.70
Pepper Grinder	6 inches ceramic	£4.45
Photo/Note Holder		£3.20
Lamp Holder	(inc plate)	£5
Lamp Holder - Safety Switch version	(inc plate)	£5.50

Sundries

Safety Glasses		£5.50
Safety Overglasses		£5.50
Empty squeeze bottle dispenser with nozzle	250ml	£1
Empty squeeze bottle dispenser with nozzle	500ml	£1.50
Face Plate Ring	Charwood	£13

Club Clothing:

Polo shirts	£12.50 + VAT
Sweatshirts	£15.50 + VAT
Full zip fleece	£19.95 + VAT
Full zip smocks	£40.00 + VAT
Baseball caps	£9.00 + VAT

If you wish to order any of the above,(which include embroidery). Please email susanbutler29@hotmail.com



**PLEASE
DONT FORGET**

**THE SPEED LIMITS
ON SITE**

So
Until the
calendar turns
over again!

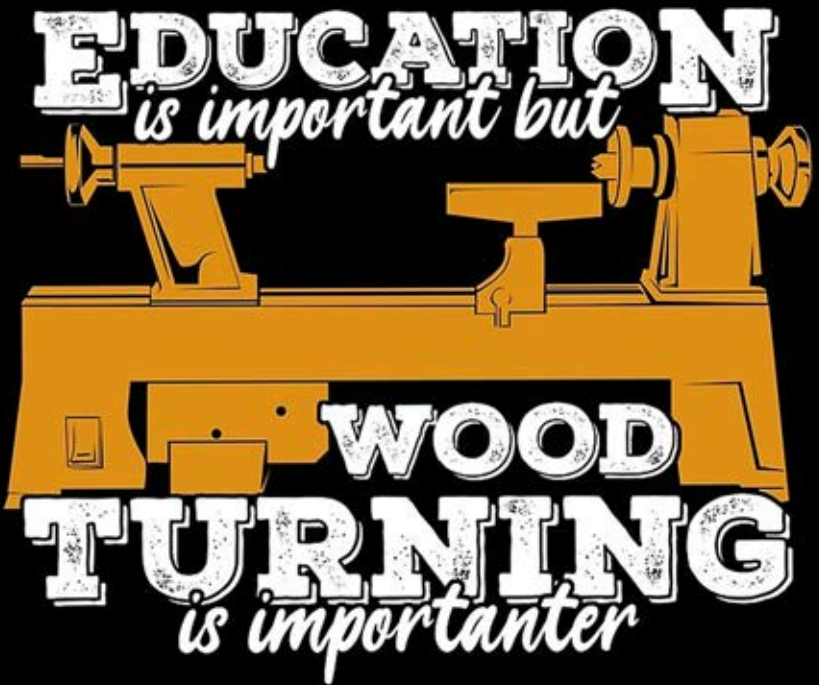

That's a wrap
for this
installment!